

TORNADO

Model
BL-600T



Thanks for Choosing Tornado
Table Blender

ELARABY



19319 www.elarabygroup.com
Tornado Elaraby

This appliance is intended to be used in household and similar applications such as:

- staff kitchen areas in shops, offices and other working environments.
- farm houses.
- by clients in hotels, motels and other residential type environments.
- bed and breakfast type environments. out of reach of children.

Important Safeguards



When using electrical appliances, to reduce the risk of fire, electric shock, and/or injury to persons, basic safety precautions should always be followed, including the following:

You should respect the following safety warnings:

 **WARNING:** The blades of the knife are extremely sharp. Handle them with caution.

1. Read all instructions carefully.
2. To protect against electric shock, do not place cord, plug or appliance in water or other liquid.
3. Close supervision is necessary when any appliance is used by or near children.
4. This appliance is not intended for use by persons (including children) with reduced physical, sensory or mental capabilities, or lack of experience and knowledge, unless instructions concerning use of the appliance by a person responsible for their safety.
5. Unplug from outlet when not in use and before cleaning.
6. Do not operate any appliance with a damaged cord or plug, in case of appliance malfunctions or if the appliance has been damaged in any manner.
7. The use of accessory attachments not recommended by manufacturer may cause malfunctions.
8. Do not use outdoors.
9. Do not let cord hang over edge of table or counter, or touch hot surfaces.
10. Do not place the appliance on or near hot gas or electric burner, or in a heated oven.
11. This product has been designed for domestic use only. Any commercial use, inappropriate use or failure to comply with the instructions, the manufacturer accepts no responsibility and guarantee is no more valid.
12. Do not use your Table Blender if any part is broken.
13. Do not put the appliance, the power cord or the plug into water or any other liquid.

Important Safeguards

14. Make sure that the cover is securely locked in place before operating the appliance.
15. Never place ingredients in the container by hand and while the appliance is in use. Always use the food pusher.
16. The blade and discs are sharp. Handle carefully. Store out of reach of children.
17. If the power cord or the plug are damaged, do not use your appliance.
18. For your own safety, please use only the original accessories and spare parts which are suitable for your appliance.
19. Never remove the lid until the knife has stopped completely.
20. This appliance is designed to process small quantities. Do not exceed the quantities indicated in these instructions for use.
21. Do not use this appliance to mix glutinous food or substance.
22. Do not use appliance for other than intended use.
23. For your safety, this appliance conforms to the appliance standards, regulations and directives of Low Voltage, Electromagnetic Compatibility, Environment, etc.

Description

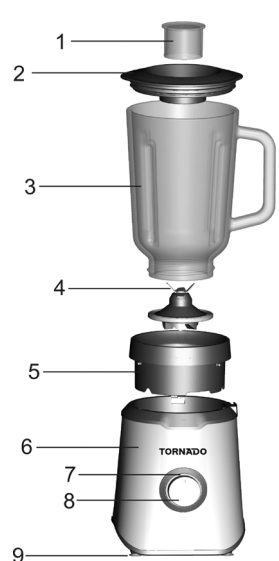
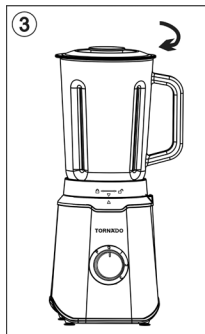
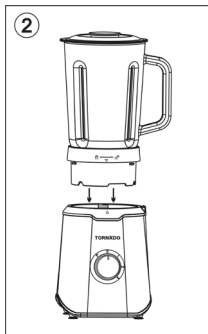

1. Measuring Cup
2. Lid
3. Glass Bowl
4. Blade
5. Glass Bowl Holder

6. Body
7. LED Indicator Light
8. Operating Switch
9. Rubber Feet

Using Your Appliance

Before first use, clean the various parts of the appliance.

Notes:

• **The start knob allows you to use 3 speeds:**

- speed 1 (slow): rotate to position 1
- speed 2 (medium): rotate to position 2
- speed 3 (fast): rotate to position 3
- Pulse function.

Mincing and Blending

- Pour in the ingredients and cover the glass bowl (Fig. 1), and then place the bowl into the host (Fig. 2) and turn clockwise (Fig. 3). Lift the glass bowl to check it is locking whether or not.
- Plug in the appliance and rotate the start knob to which speed you need.
- At the end of preparation, rotate the start knob to position 0, unplug the appliance and wait until the blades come to a complete stop.
- Remove the glass bowl and take off the lid, then pour out the ingredients.

Baby Food

To mix or blend cooked food:

- Chop the food into small pieces, add some broth (meat or vegetables) and mix the ingredients with pulses. To blend the mixed food, rotate the start knob till you reach the desired result.

For fruit preserves:

- Chop the fruits into small pieces, add some milk, water or juice and mix the ingredients with pulses. To blend the fruits, rotate the start knob till you reach the desired result.

⚠ CAUTION: Maximum time of processing should not exceed 10 second continuous use. In order to achieve below processing times, use the appliance with pulses and intermediate 10 second pauses.

⚠ CAUTION: DO NOT OPERATE THE UNIT WHEN EMPTY.

⚠ CAUTION: DO NOT PUT HOT INGREDIENTS INTO THE BOWL. BEFORE FOOD PREPARATION, ALLOW FOOD TO COOL DOWN FOR A FEW MINUTES.

⚠ CAUTION: Before you eat or serve blended food, please always check for ingredients that might have not been blended adequately.

Using Your Appliance

GENERAL:

For better results: please make sure that the quantity of ingredients fully covers the blade while chopping solid food.

Care and Cleaning

- Always unplug the appliance first.
- Only use a damp sponge to clean the motor unit. Never place it in water, or under running water.
- The bowl, the blade and the lid can all be cleaned in the dishwasher (upper basket).

TECHNICAL SPECIFICATION

Voltage: 220-240V~50/60Hz Power: 600W Class II

Environment friendly disposal

You can help protect the environment!
Please remember to respect the local regulations:
hand in the non-working electrical equipments to an
appropriate waste disposal center.



ELARABY



19319  www.elarabygroup.com
 Tornado Elaraby